

NOMENCLATURA

- 1 - Cuerpo-brida
- 3 - Tapa
- 4 - Turbina
- 5 - Eje
- 7 - Motor
- 8 - Cierre mecánico
- 11 - Chaveta
- 12 - Tornillo
- 13 - Junta plana
- 14 - Paragotas
- 15 - Prisionero
- 16 - Recubrimiento
- 17 - Tornillo
- 18 - Tripode
- 19 - Tornillo
- 20 - Arandela
- 21 - Protector
- 22 - Tornillo
- 23 - Tornillo

NOMENCLATURE

- 1 - Body-flange
- 3 - Cover
- 4 - Impeller
- 5 - Shaft
- 7 - Motor
- 8 - Mechanical seal
- 11 - Key
- 12 - Screw
- 13 - Gasket
- 14 - Splash protection
- 15 - Setscrew
- 16 - Casing
- 17 - Screw
- 18 - Tripod
- 19 - Screw
- 20 - Washer
- 21 - Protector
- 22 - Screw
- 23 - Screw

NOTA: Las piezas de recambio recomendadas están coloreadas. / NOTE: The recommended spare parts are coloured in.

CARACTERÍSTICAS TÉCNICAS

Caudal..... Q = 1 a 40 m³/h
 Altura manométrica..... H = 5 a 60 mca
 Motores..... P = 1 a 20 hp
 (0.75 a 15 kW)
 Temperatura..... T = 100°C
 (cierre esp. 130°C)
 Material..... AISI-316L

DESCRIPCIÓN

Bomba autoaspirante hasta 5 m sin válvula de pie. Basada en el principio del canal lateral, permite igualmente vehicular líquidos conteniendo gases en disolución sin descebarse.

La bomba RAPIT-SS es el resultado de la evolución y mejoras técnicas de la anterior RAPIT-S. Éstas son:

- Turbina fija.
- Cierre mecánico interior.

-Cuerpo-brida de nuevo diseño y gran solidez en acero inoxidable fundido. Esta

pieza contiene por un lado el canal lateral con la aspiración y la impulsión y por el otro la brida de fijación al motor. Pulido espejo exterior.

- Tapa delantera fija, pulida espejo exterior.
- Turbina radial abierta tipo estrella, fija, con aro de refuerzo exterior.
- Eje intercambiable, independiente del motor.

- Cierre mecánico simple interior Burgmann. Posible otros tipos.
- Tripode graduable.

- Protector seguridad cuerpo-brida CE inoxidable.

- Motor IEC IP-55 (posible EEX)
- Recubrimiento motor en acero inoxidable.
- Ventilado. Conexión eléctrica dentro del motor estanco.

Equipada con roscas DIN-11851 (posible SMS, FIL, CLAMP).

APLICACIONES

Aguas, vino, alcoholes, mostos, zumos, salmuera, etc.

TECHNICAL SPECIFICATIONS

Flow rate..... Q = 1 to 40 m³/h
 Total head..... H = 5 to 60 mwc
 Motors..... P = 1 to 20 hp
 (0.75 to 15 kW)
 Temperature..... T = 100°C
 (special seal 130°C)
 Material..... AISI-316L

DESCRIPTION

Self-suction pump to 5 metres, without foot valve. Based on the side-channel principle, it permits liquids containing gases in solution to be pumped without de-priming the pump.

The RAPIT-SS pump is the result of technical evolution and improvements to the previous RAPIT-S. These are:

- Fixed impeller.
- Internal mechanical seal.

-New design, high strength, cast stainless steel body-flange. This part contains the

side channel with suction and impulsion on one side and the motor fixing flange on the other. Mirror polished exterior.

- Fixed front cover, mirror polished finish.
- Fixed star type open radial impeller, with exterior reinforcement ring.

- Replaceable shaft, independent of the motor.

- Single internal mechanical seal, Burgmann type. Other types possible.
- Adjustable tripod.

- Stainless steel CE body-flange safety protector.

- Motor IEC IP-55 (possible EEX).
- Stainless steel motor casing. Ventilated. Electrical connections under motor cover.

Fitted with DIN-11851 threads (possible SMS, FIL, CLAMP)

APPLICATIONS

Water, wine, alcohol, must, juices and brine etc.

■ CURVAS CARACTERÍSTICAS / CHARACTERISTIC CURVES

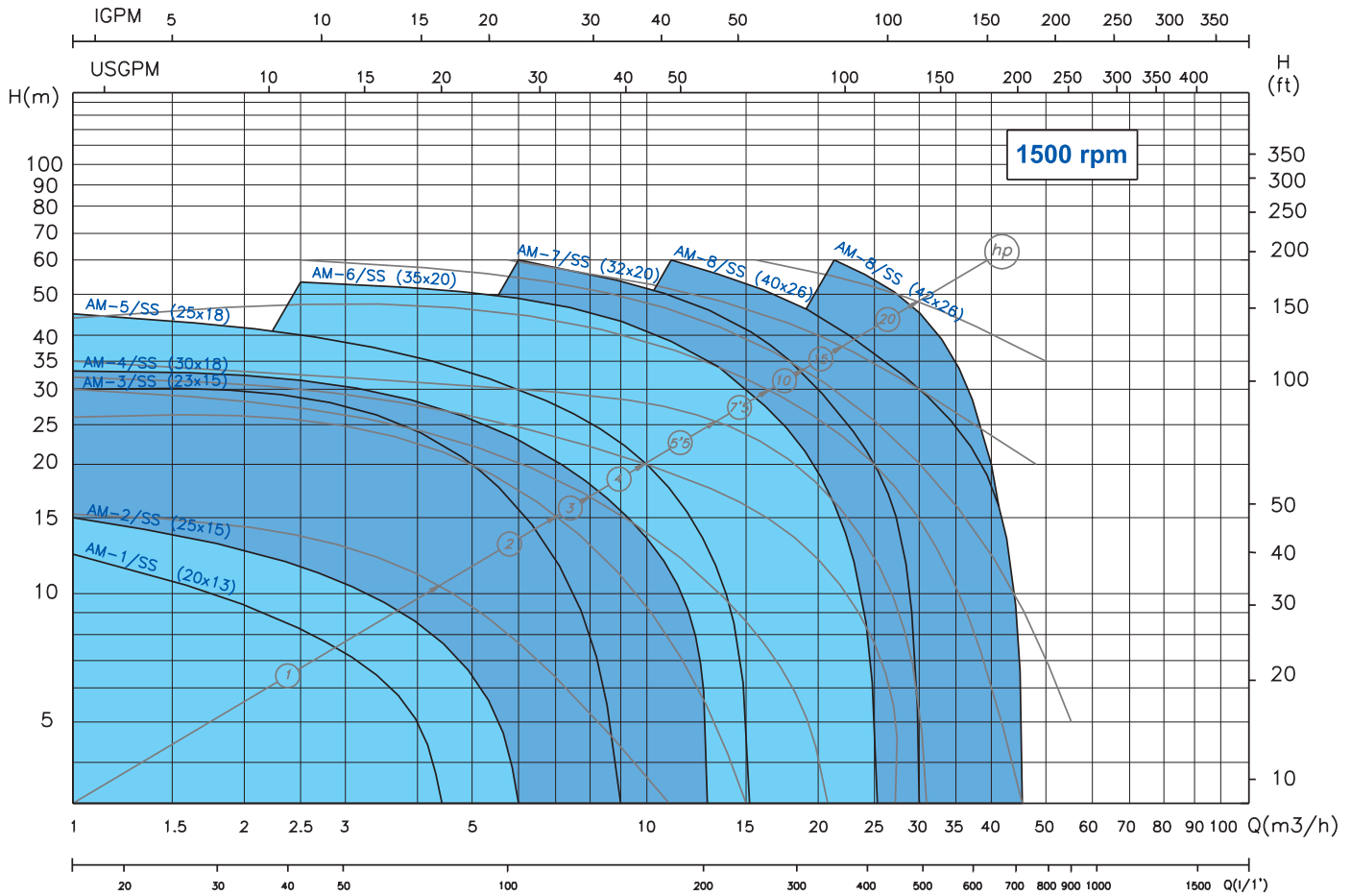

NOTA: Estas curvas se entienden para líquido no viscoso de densidad 1 cST. / NOTE: The curves are understood to be for non-viscous liquids with a density of 1 cST.

■ DIMENSIONES / DIMENSIONS

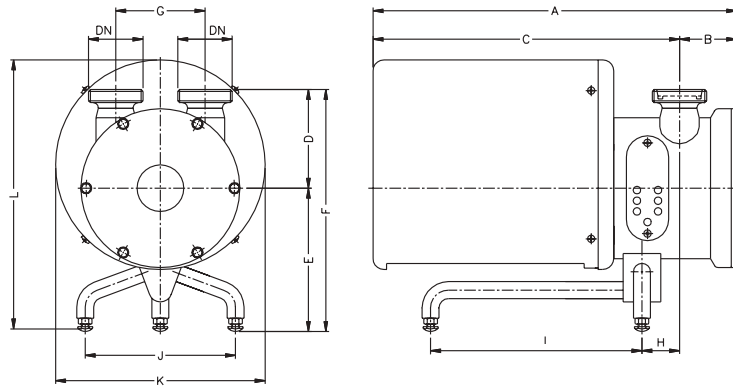

| TIPO / TYPE | MOTOR / MOTOR | | | | DIMENSIONES / DIMENSIONS (mm) | | | | | | | | | | | | | PESO / WEIGHT (kg) |
|-------------|---------------|--------|---------|------|-------------------------------|----|-----|-----|-----|-----|-----|----|-----|-----|-----|-----|-------|--------------------|
| | TAMAÑO / SIZE | hp | kW | rpm | A | B | C | D | E | F | G | H | I | J | K | L | DN | |
| AM-1/SS | 80B | 1 | 0.75 | 1500 | 388 | 61 | 327 | 105 | 152 | 257 | 75 | 40 | 225 | 160 | 223 | 288 | NW-32 | 25.5 |
| AM-2/SS | 90L | 2 | 1.5 | 1500 | 428 | 67 | 367 | 140 | 201 | 341 | 100 | 43 | 275 | 200 | 268 | 321 | NW-40 | 31 |
| AM-3/SS | 90L | 2 | 1.5 | | 448 | | 381 | | | | | | | | 268 | 362 | | 34 |
| AM-4/SS | 100LA | 3 | 2.2 | 1500 | 501 | 78 | 434 | 165 | 256 | 421 | 130 | 53 | 400 | 300 | 322 | 396 | NW-50 | 42 |
| | AM-5/SS | 100LB | 4 | | | | | | | | | | | | | | | 3 |
| AM-6/SS | 112M | 5.5 | 4 | 1500 | 533 | 94 | 550 | 200 | 281 | 481 | 150 | 61 | 400 | 300 | 378 | 469 | NW-65 | 70 |
| AM-7/SS | 100L | 3-4 | 2.2-3 | | | | | | | | | | | | | | | 618 |
| AM-8/SS | 132S/M | 7.5-10 | 5.5-7.5 | 1500 | 644 | 94 | 705 | 200 | 281 | 481 | 150 | 61 | 400 | 300 | 378 | 494 | NW-65 | 105-115 |
| AM-8/SS | 160M | 15 | 11 | | | | | | | | | | | | | | | 799 |
| | 160L | 20 | 15 | | | | | | | | | | | | | | | 160 |



Bominox, S.A.
Ctra. Banyoles, km.14
17844 Cornellà de Terri (Girona) Spain
Apart.123 Banyoles

Tel. 34 972 59 50 20
Fax 34 972 59 51 20
E-mail: info@bominox.com
www.bominox.com